

Several Courses and distances
up the river Conemaugh.

- S. 30 W. 158.
- S. 16. E. 55.
- S. 70. E. 132.
- N. 61. E. 67.
- N. 52. E. 132.
- N. 7. E. 105.
- N. 77. W. 128.
- 777

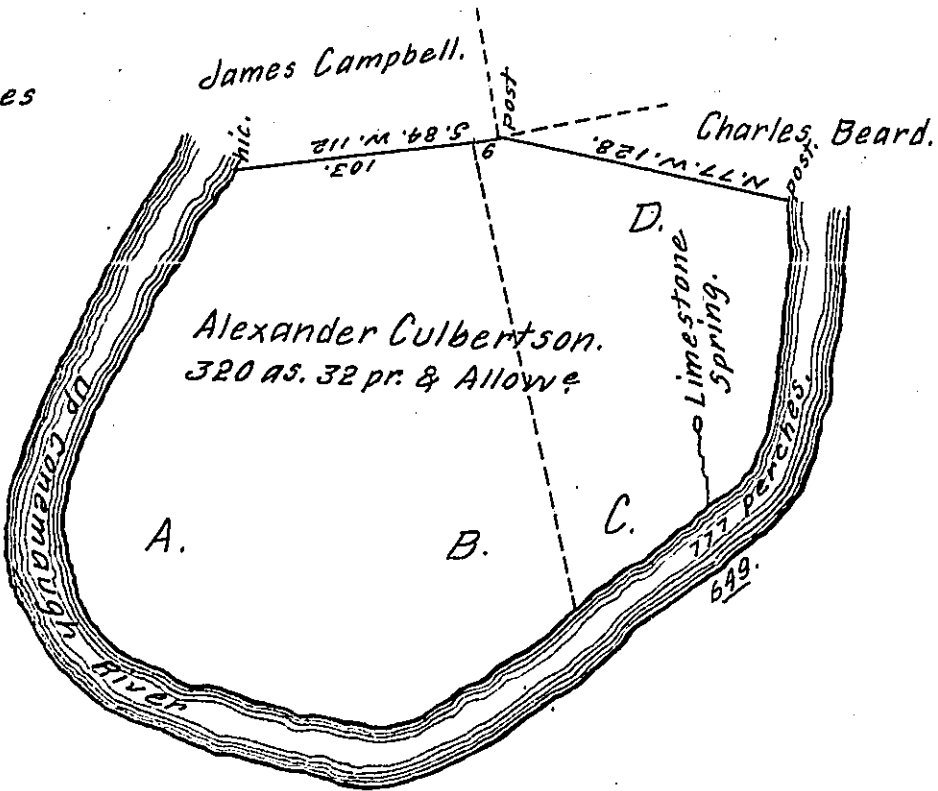

In pursuance of the Several acts of Assembly directing the recovery of the principal and interest due to the Commonwealth from persons holding lands by virtue of Locations and other office titles issued from or under the Proprietary Government And by the authority of the board of Property, I have this 22d. day of February, 1828. Surveyed the above described tract of land containing Three hundred and twenty and thirty two perches and allowance of Six per Cent adjoining lands of James Campbell and Charles Beard on a limestone Spring on the N. W. side of Conemaugh River about 1/2 mile above the mouth of Mc. Gees run Situate in Blacklick Township in the County of Indiana. By virtue of a Location No. 1600 granted to Alexr. Culbertson on the 3d. of April 1769.

To Gabriel Heister, Esquire
Surveyor General.

John Taylor, D.S.
No. 1648. Patd.
W. Beard Patd.

N.B. That part of the above Survey represented by the dotted line and the letters A. & B. was Surveyed on the 3d. of May, 1770. to Thos. Freeman by order of the 3d. April, 1769. No. 1648. and the residue including the letters D. & C. was Surveyed the 1 May 1786. By warrant of the 13th. February, 1786. granted to William Beard.

IN TESTIMONY that the above is a copy of the original remaining on file in the Department of Internal Affairs of Pennsylvania, made conformably to an Act of Assembly approved the 16th day of February, 1833, I have hereunto set my Hand and caused the Seal of said Department to be affixed at Harrisburg, this fourteenth day of September 1908.

Henry A. ...
Secretary of Internal Affairs.